

BEVERLYWOOD WEST HOMEOWNERS ASSOCIATION

~ 11260 Overland Avenue ~ Culver City, CA 90230 ~

December 6, 2005

RE: ROAD SLURRY

To all Homeowners and Residents:

On Monday, December 12, 2005 the first phase of the road slurry in your association will begin. It will consist of thick, black compound that will be spread over the roadway and asphalt driveway areas. When the 1st phase begins on Monday, December 12th they will begin the south drive slurry, and come back on Tuesday December 13th and re-stripe that entire road. The 2nd phase will proceed the same way, Wednesday, December 14th will be the slurry for the entire north drive area and re-stripe on Thursday December 15th. Please see map of the entire complex is included with this notice. It is a color-coded map with the 1st phase in pink and the 2nd phase of the road slurry project is in yellow. The 1st phase will begin at the south drive area and the 2nd phase will be the north drive.

During the 1st phase those buildings affected will need to park on the north drive area or out on Overland Avenue for 2 days or until the road barriers are taken down. Homeowners affected by the 2nd phase will have to move their cars over to the south drive area or visitor parking, and or out on Overland Avenue or surrounding streets.

This is a short inconvenience for everyone, including the postman, who will need to deliver the mail by hand to many residents on the days of the slurry and driving.

WE HAVE ARRANGED THAT THE TRASH WILL BE PICKED UP ON FRIDAY, DECEMBER 16, 2006.

Sincerely,

For the Beverlywood Homeowners Association

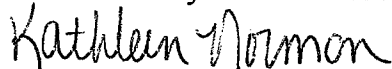

Kathleen Norman

Classic Property Management

CLASSIC PROPERTY MANAGEMENT, CO., INC.

~2235 Sepulveda Boulevard, 2nd Floor Suite ~ Torrance CA 90501 ~

~PH: (310) 972-9999 #37 FAX: (310) 972-9988 E-mail: Kathleen@Cpm.to

~

LOOK CODE CHART: ROAD > 1000

1st Phase - 12-12-05 & 12-13-05

2nd Phase - 12-14-05 & 12-15-05

BEVERLYWOOD WEST TOWHOUSES
11260 OVERLAND AVENUE
CULVER CITY CA

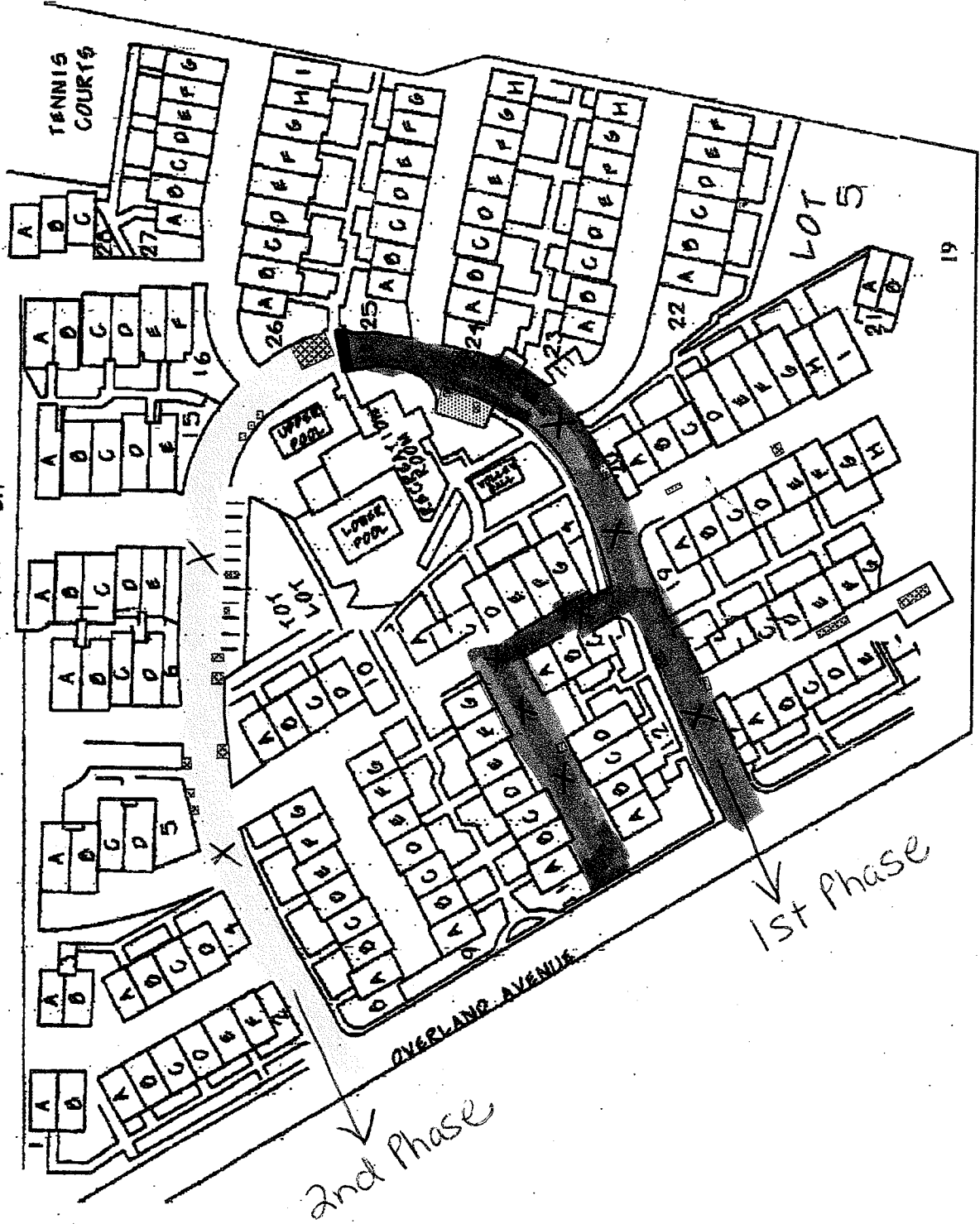

Legend:

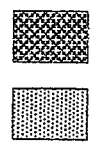

Areas of Asphalt Removal and Replacement
Areas of Asphalt Overlay